

# Rotary Axis (DesignSpark)

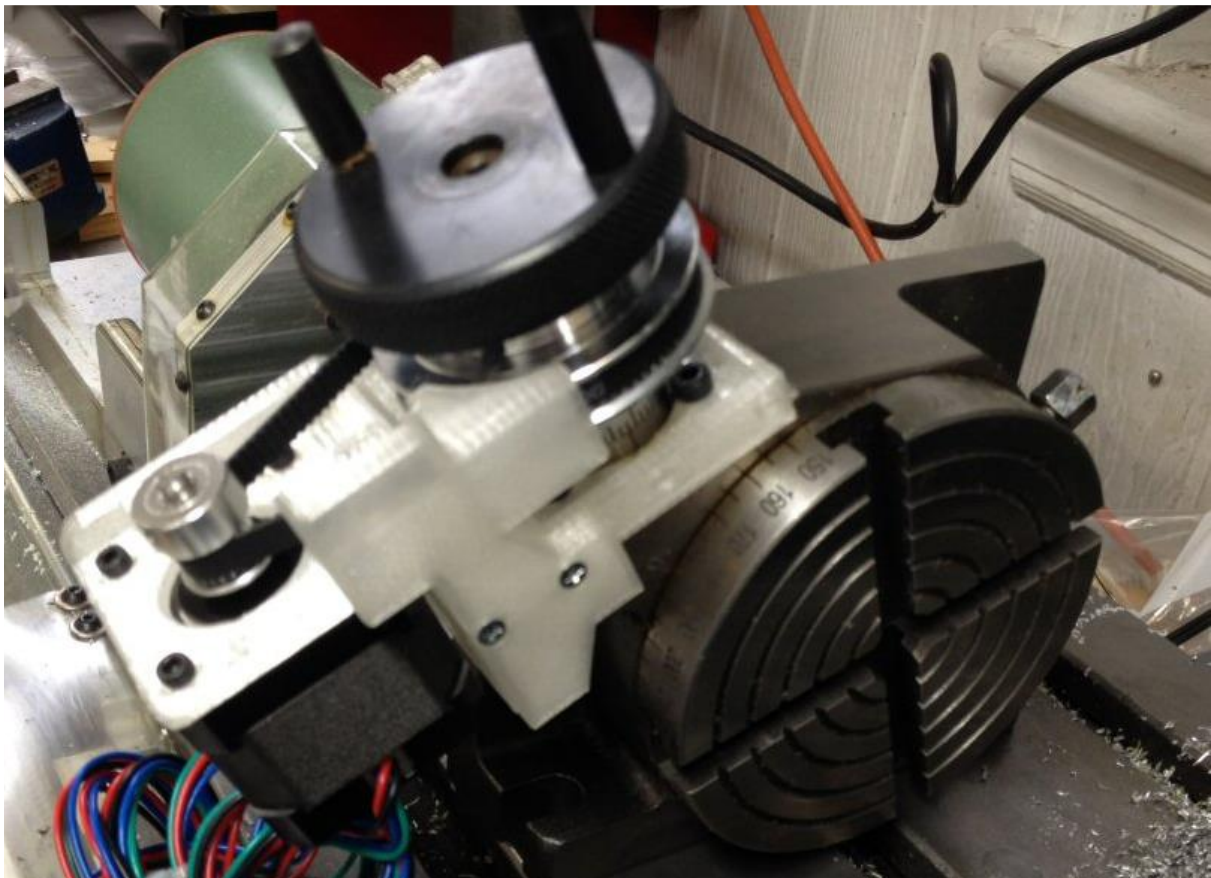

# Exploded View (Screws not shown)

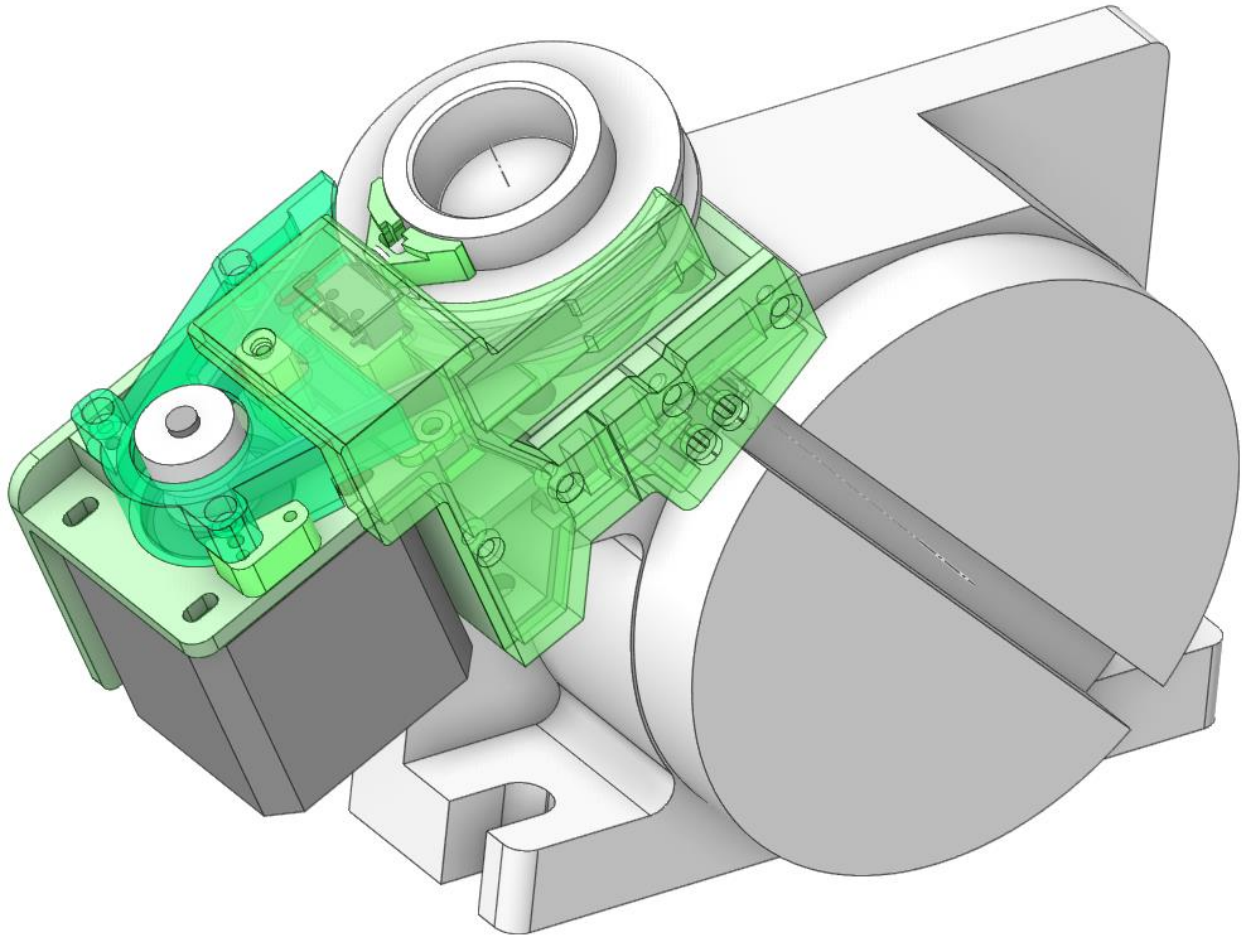
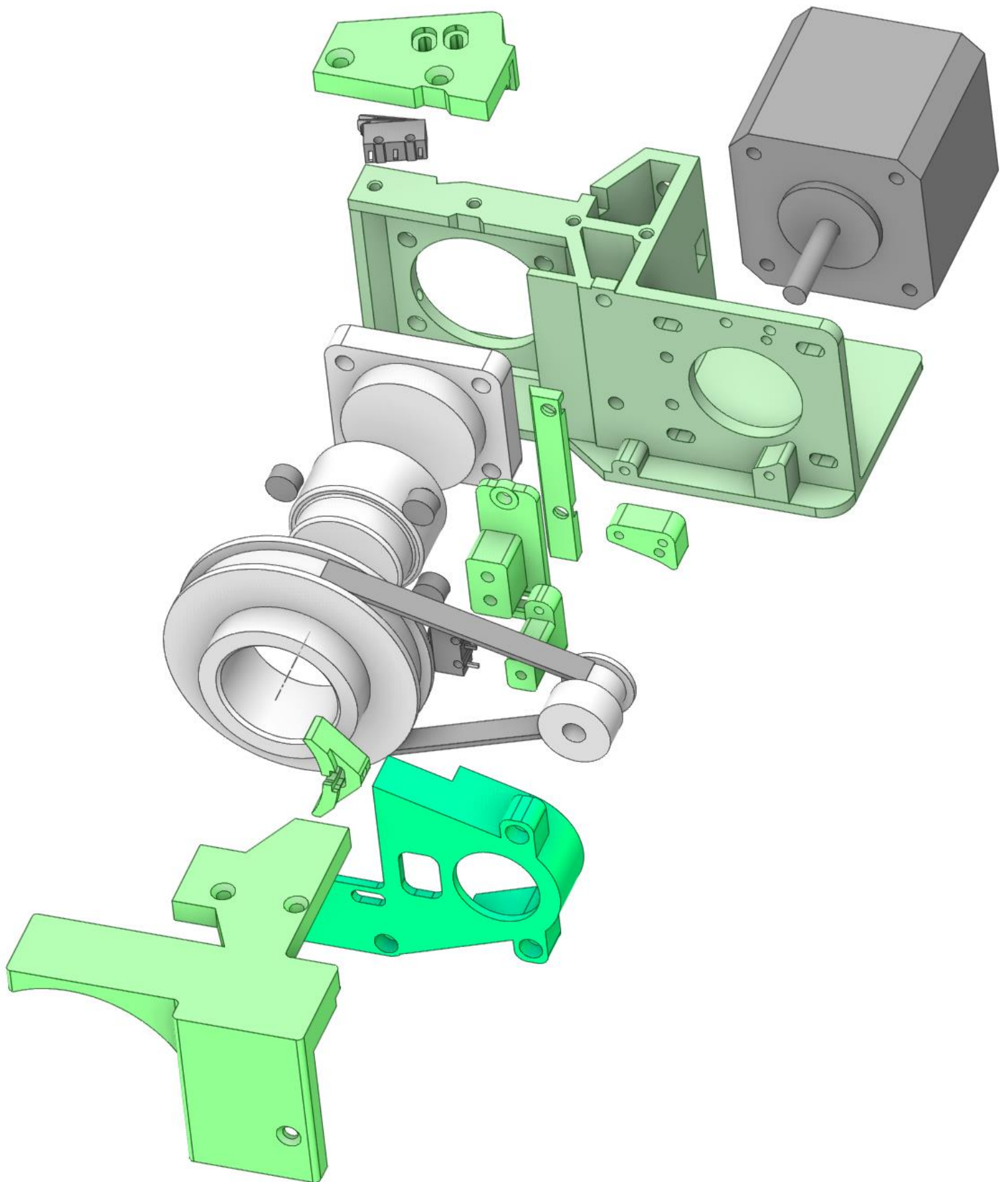

# Machining GT2 (2mm pitch) 80T (80 Teeth) Pulley

Many rotary tables have hand wheel assemblies with large diameter hubs that provide a location for a drive pulley. The bore of a purchased pulley will likely need to be opened. This could possibly be done on a drill press, but the best method is to use a boring bar on a lathe.

Original Pulley with 5mm bore



Initial drilling with 7/8" drill bit



Using a boring bar to finish bore size



Using a boring bar to chamfer edge



Using a boring bar to chamfer far edge



Using a boring bar to chamfer far edge



## BOM (Bill Of Materials)

Line	Qty	Type	Description	Part Num	Price
1	4	Screw	#4 1/2"L FlatHead ThreadForming Steel ZincPlated	90434A115	\$6.18(100)
2	8	Screw	#2 3/8"L RoundHead SheetMetalBlunt Steel ZincPlated	90056A079	\$4.78(100)
3	4	Screw	M3x0.5 8mmL SocketHead 18-8SS	91292A112	\$5.94(100)
4	4	Washer	M3 3.2mmID 7mmOD 0.4mm-0.6mmThick	93475A210	\$2.41(100)
5	2	Switch	Limit 0.5"x0.226" 0.256"H	SS0750301F040P1A	\$1.06(1)
6	2	Misc	4" Rotary Table	B0B93LPDWR	\$89.99(1)
7	1	Motor	Stepper Mena17 5mmShaft 180Steps 45Ncm 2A 1.3Ohm	17HS16-2004S1	\$13.99(1)
8	2	Pulley	GT2 Pulley 5mmBore 20T	B0GH7HK6FX	\$5.99(5)
9	1	Pulley	GT2 Pulley 5mmBore 80T	B08JTS1DRK	\$9.99(1)
10	1	Belt	GT2 6mm Belt 200mm and other lengths	B0DZ6TKM8Z	\$7.43(1)
11	1	printPLA	Bracket		
12	1	printPLA	LimitSwitchTableMount		
13		printPLA	BeltCoverMount		
14	1	printPLA	NutHolder		
15	1	printPLA	LimSwPulleyMount		
16	1	printPLA	TopCoverMount		
17	1	printPLA	HomingPoint		
18	1	printPLA	BeltCover		
19	1	printPLA	TopCover		



[Click to see full view](#)



### 4" (100mm) Rotary Table for Milling Machine with Horizontal & Vertical 4 Slots - Precision Rotary Tool Set for Accurate Positioning - Smooth & Efficient Machining Operation

Visit the RAHISH TOOLS Store

3.5 ★★★★★ (10) | [Search this page](#)

\$89<sup>99</sup>

[Price history](#)

Or \$15<sup>00</sup> /mo (6 mo) at 0% APR. [Select from 2 plans](#)

[prime](#) Tomorrow

FREE Returns

Save up to 1% with business pricing. [Sign up for a free Amazon Business account](#)

Size: **4Inch Rotary**

**4Inch Rotary**

\$89.99  
FREE Delivery  
Tomorrow

**4Inch Rotary + 65mm...**

\$134.99  
FREE Delivery  
Tomorrow

**4Inch Rotary + M6 Clam...**

\$94.99

**4Inch Rotary + 65mm...**

\$144.99



Click to see full view



# STEPPERONLINE Stepper Motor Nema 17 Bipolar 40mm 64oz.in(45Ncm) 2A 4 Lead 3D Printer Hobby CNC

Visit the STEPPERONLINE Store

4.4 ★★★★★ (224) | Search this page

Overall Pick

\$13<sup>99</sup>

Price history

prime Overnight

FREE Returns

Save up to 8% with business pricing. Sign up for a free Amazon Business account

Brand	STEPPERONLINE
Speed	200 RPM
Voltage	24 Volts
Horsepower	1.1 Horsepower
Product	1.65"W x 1.65"H
Dimensions	

## About this item

- Nema 17 Stepper Motor with High torque
- 45Ncm(63.7oz.in) holding torque
- NEMA 17 bipolar 1.65"x1.65"x1.57" 4-wire
- 1.8 deg. step angle(200 steps/rev)
- Rated current 2A & resistance 1.1ohms



# WINSINN GT2 Pulley 20 Teeth 6mm bore 6mm Width 20T Timing Belt Pulley Wheel Aluminum for 3D Printer (Pack of 5Pcs)

Visit the WINSINN Store

4.7 ★★★★★ (941) | Search this page

Overall Pick

100+ bought in past month

\$5<sup>99</sup>

Price history

prime Overnight

FREE Returns

Save up to 1% with business pricing. Sign up for a free Amazon Business account

Size: 6mm Belt



Click to see full view

**6mm Belt**

\$5.99

FREE Delivery

Overnight 4 AM - 8 AM

See 1 options with no featured offers

Style: 20 Tooth 6mm Bore



## 5mm Bore GT2 80T Pulley Synchronous Wheel 2GT Timing Belt Pulley 80 Teeth Compatible with Voron 2.4 3D Printer 6mm Width Belt

Visit the [HOCENWAY Store](#)

4.5 (45) | [Search this page](#)

**Amazon's Choice**



\$9<sup>99</sup>

[Price history](#)

**prime Tomorrow**

FREE Returns

Save up to 5% with business pricing. Sign up for a free Amazon Business account

Size: **6mm Belt width**

**6mm Belt width**

\$9.99  
FREE Delivery  
Tomorrow

See 1 options  
with no  
featured offers

Style: **5mm bore**

5mm bore

8mm bore

10mm bore

[Click to see full view](#)



## Gt2 Belt, 8 Pcs 3D Printer Timing Belt 3D Printer Open Synchronous Belt 110mm 112mm 122mm 158mm 200mm 280mm 300mm 400mm Width 6mm for 3D Printer Motor Belt

Brand: [KALIONE](#)

4.5 (20) | [Search this page](#)

**Amazon's Choice**

\$7<sup>43</sup> (\$0.93 / count)

[Price history](#)

**prime Tomorrow**

FREE Returns

**Material** Rubber

**Brand** KALIONE

**Item dimensions L x W x H** 5.12 x 3.54 x 0.71 inches

**Set Name** Gt2 Belt

**Unit Count** 8.0 Count



[Click to see full view](#)



Image shown is a representation only. Exact specifications should be obtained from the product data sheet.



## SS0750301F040P1A

**DigiKey Part Number** EG4924-ND

**Manufacturer** [E-Switch](#)

**Manufacturer Product Number** SS0750301F040P1A

**Description** SWITCH SNAP ACTION SPDT 3A 125V

**In-Stock: 28,061**

[Check for Additional Incoming Stock](#)

QUANTITY

Add to List

Add to Cart

All prices are in USD

### Bulk

QUANTITY	UNIT PRICE	EXT PRICE
1	\$1.06000	\$1.06
10	\$0.88000	\$8.80
25	\$0.81600	\$20.40
50	\$0.77100	\$38.55
 120	\$0.71758	\$86.11
360	\$0.65575	\$236.07